

36th International Cosmic Ray Conference



University of Wisconsin-Madison
Madison, Wisconsin, USA

Welcome to the 36th International Cosmic Ray Conference in Madison

The most recent ICRC in the US was 20 years ago, 1999 in Salt Lake City.

We are pleased to host this ICRC on behalf of:

- UW-Madison
 - Department of Physics
 - Department of Astronomy
 - WIPAC (Wisconsin IceCube Particle Astrophysics Center)
- and the US AstroParticle Physics community

Credit for the scientific program goes primarily to the ISPC and the International Advisory Committee.

Local Organizing Committee

Albrecht Karle - University of Wisconsin-Madison, Chair

Michael DuVernois - University of Wisconsin-Madison

Cary Forest - University of Wisconsin-Madison

Thomas K. Gaisser - University of Delaware

Francis Halzen - University of Wisconsin-Madison

Kael Hanson - University of Wisconsin-Madison

Jim Madsen - University of Wisconsin-River Falls

Angelo Olinto - University of Chicago

Kim Palladino - University of Wisconsin-Madison

Justin Vandenbroucke - University of Wisconsin-Madison

Scott Wakely - University of Chicago

Ellen Zweibel - University of Wisconsin-Madison



Map

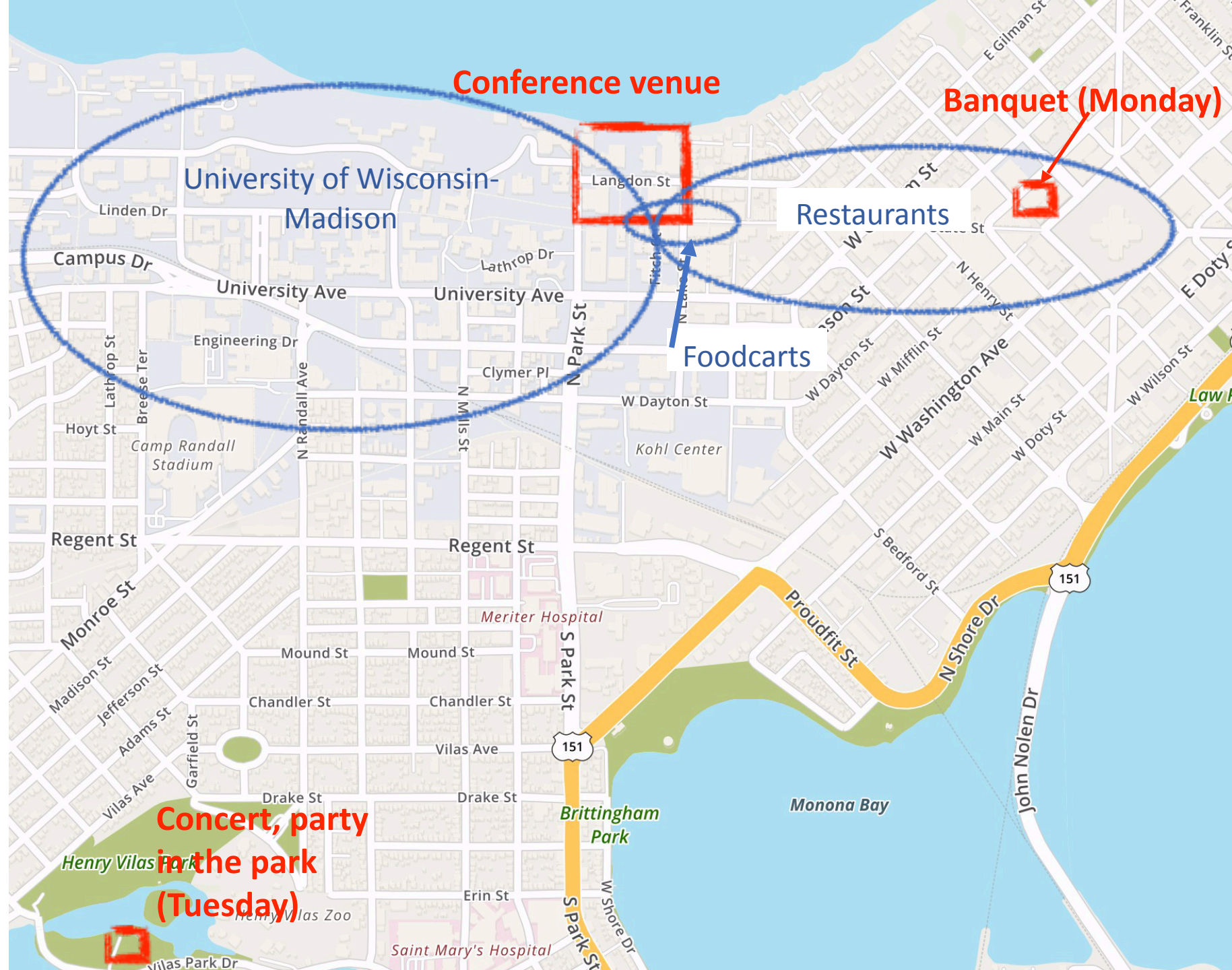

Conference Venue

All sessions & programming take place in the:

- Memorial Union
- Pyle Center
- Wisconsin Historical Society

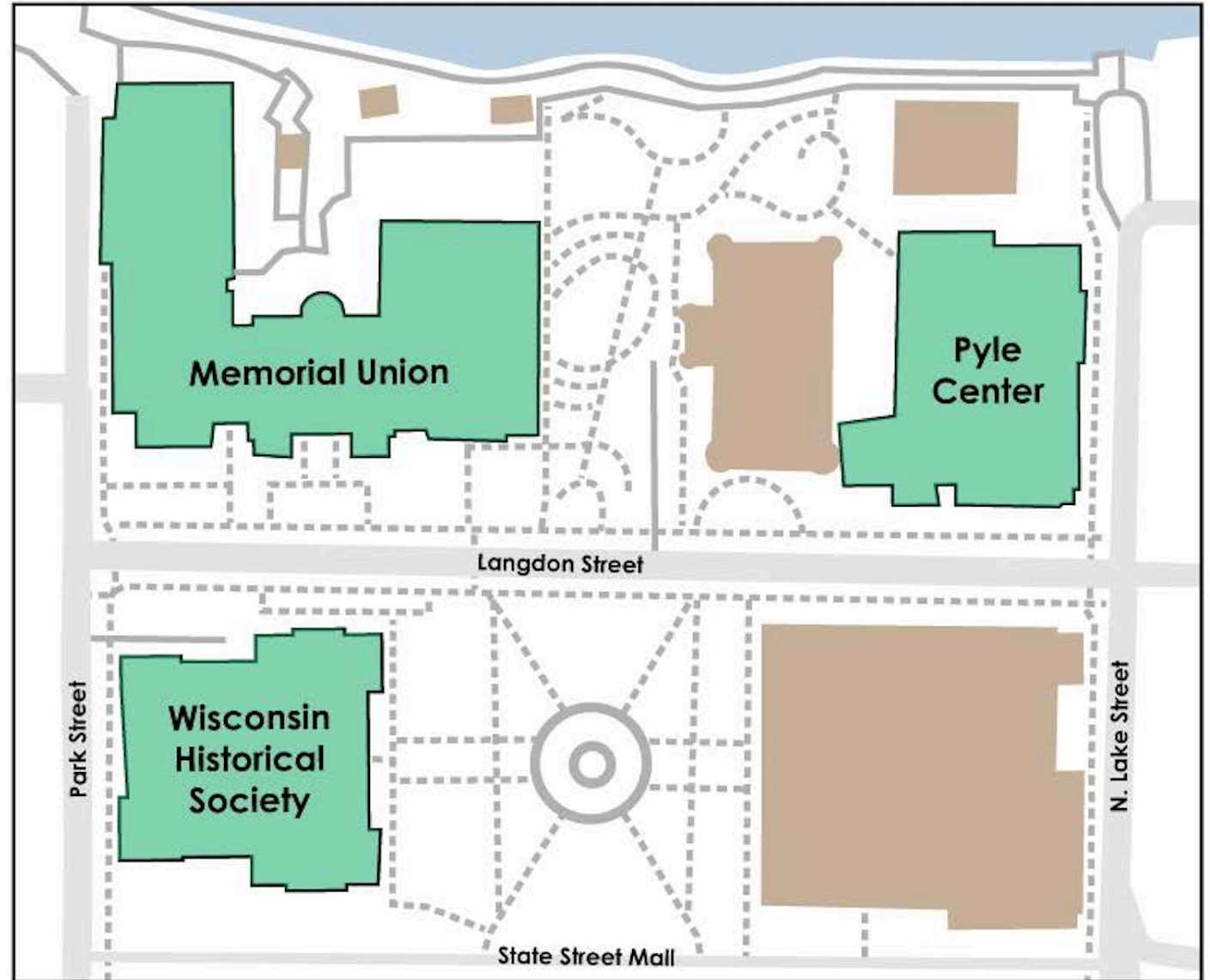

ICRC2019

Madison, WI, USA

University of Wisconsin Memorial Union

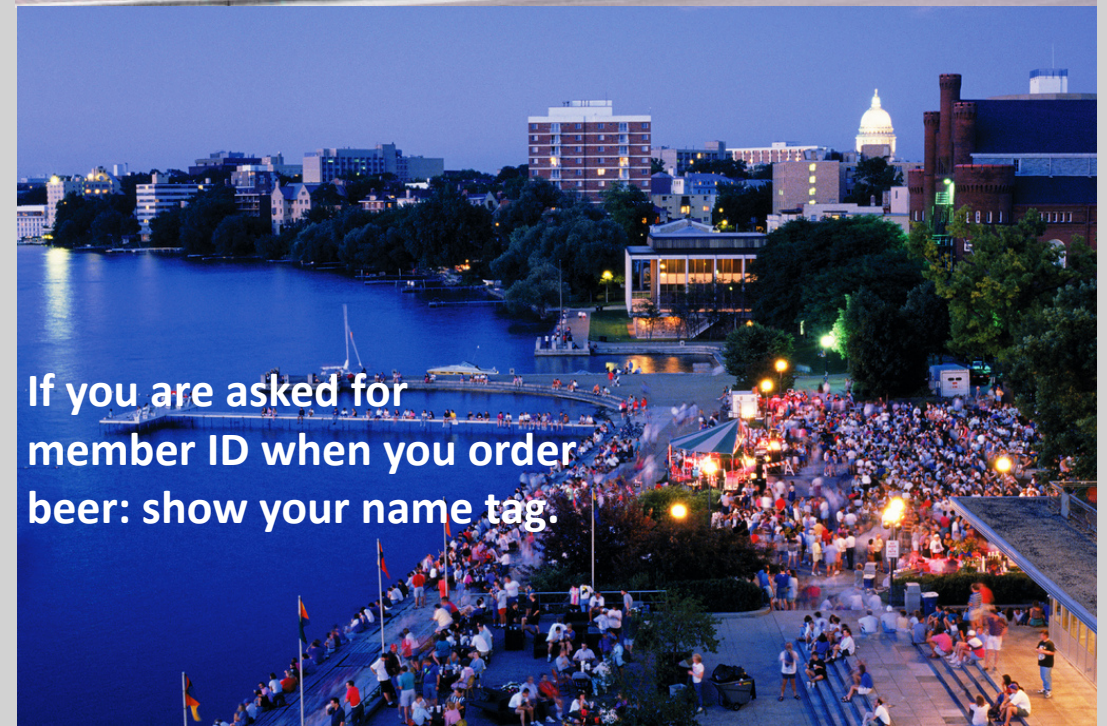

If you are asked for
member ID when you order
beer: show your name tag.

Banquet Venue

**Governor's Club
at the
Concourse Hotel**

One block off Capitol Square

Monday, July 29th
18:30-22:00



ICRC Program

- ICRC Webpage
- ICRC App
- ICRC book (PDF)



Time	24 July (Wed)	25 July (Thurs)	26 July(Fri)	27 July (Sat)	28 July (Sun)	29 July (Mon)	30 July (Tues)	31 July (Wed)	1 Aug (Thurs)
8:30		Opening Session	Review Talks 1. Francis Halzen 2. Katherine Blundell	Review Talks 1. Tim Linden 2. Reshmi Mukherjee	Open Day & Excursion	Review Talks 1. Ellen Zweibel 2. Imre Bartos	Review Talks 1. Abigail Vieregge 2. Gwenael Giacinti	Review Talks 1. Norma Crosby 2. Rasha Abbasi	Rapporteur Talks
9:00									
9:30									
10:00		Coffee	Coffee	Coffee		Coffee	Coffee	Coffee	Coffee
10:30		Highlight Talks 1. Antonella Castellina 2. Michael Daniel 3. Razmik Mirzoyan	Highlight Talks 1. Ke Fang 2. Shoichi Ogio 3. Elisabetta Bisaldi	Highlight Talks 1. Yoichi Asaoka 2. Dennis Soldin 3. Bruna Bertucci		Highlight Talks 1. Dawn Williams	Highlight Talks 1. Arik Posner 2. ... 3. ...	Highlight Talks 1. Qiang Yuan 2. Fusa Miyake 3. Kirsten Tollefson	Coffee
11:00					Rapporteur Talks				
11:30									
12:00		Lunch Break	Lunch Break	Lunch Break	Excursions: 1. Devil's Lake 2. Chicago (city trip)	Lunch Break	Lunch Break	Lunch Break	
12:30									Lunch Break
13:00									
13:30		Parallel Sessions CRI1: Shannon Hall GAI1: Historical Society NU1: Pyle Rm. 313 CRD1: Play Circle SH1: Pyle Rm. 309	Parallel Sessions CRI3: Shannon Hall GAI3: Historical Society NU3: Pyle Rm. 313 CRD3: Play Circle GAD3: Festival	Parallel Sessions NU5: Shannon Hall CRI5: Historical Society CRI6: Pyle Rm. 313 SH4: Play Circle GAD4: Festival	Parallel Sessions CRI9: Shannon Hall GAI6: Historical Society NU7: Pyle Rm. 313 SH5: Play Circle GAD5: Festival	Parallel Sessions CRI11: Shannon Hall GAI9: Historical Society NU8: Pyle Rm. 313 CRD7: Play Circle DM2: Festival	Parallel Sessions NU10: Shannon Hall CRI13: Historical Society CRI14: Pyle Rm. 313 SH7: Play Circle GAD6: Festival	Rapporteur Talks	
14:00									
14:30									
15:00		Poster Session 1 Coffee	Poster Session 1 Coffee	Poster Session 2 Coffee	Poster Session 2 Coffee	Poster Session 3 Coffee	Poster Session 3 Coffee	Coffee	
15:30									
16:00									
16:30		Parallel Sessions CRI2: Shannon Hall GAI2: Historical Society CRD2: Pyle Rm. 313 SH2: Pyle Rm. 309 NU2: Play Circle	Parallel Sessions CRI4: Shannon Hall GAI4: Historical Society NU4: Pyle Rm. 313 CRD4: Play Circle SH3: Pyle Rm. 309	Parallel Sessions GAI5: Shannon Hall CRI7: Historical Society CRD5: Pyle Rm. 309 CRI8: Pyle Rm. 313 NU6: Play Circle	Parallel Sessions CRI10: Shannon Hall GAI7: Historical Society GAI8: Pyle Rm. 313 CRD6: Play Circle DM1: Festival	Parallel Sessions CRI12: Shannon Hall GAI10: Historical Society NU9: Pyle Rm. 313 CRD8: Play Circle SH6: Pyle Rm. 309	Parallel Sessions GAI11: Shannon Hall CRI15: Pyle Rm. 313 NU11: Historical Society CRI16: Play Circle DM3: Festival	Rapporteur Talks	
17:00									
17:30									
18:00	Registration & Welcome Party	Diversity Panel with Amy Wendt & Ice Cream Social	Public Lecture Alan Watson Hess Lecture		Banquet Concourse hotel	Concert, party in the park			
18:30									
19:00									
19:30									
20:00									
20:30									
21:00									
21:30									

Excursions:
1. Devil's Lake
2. Chicago (city trip)

ICRC App for Phone or Tablet

Access to the meeting schedule and updates

1. Download “The Event App” by EventsAir
2. Enter Event Code **icrc2019** and click **Submit**
3. Log into the Mobile App



The Event App by EventsAIR

Centium Software Pty Ltd Business

★★★★★ 96

 Everyone

 You don't have any devices.

 Add to Wishlist

Install

Livestreaming and Access to Presentations

- All review, highlight and rapporteur talks will be livestreamed at:
<https://events7.mediasite.com/Mediasite/Catalog/catalogs/icrc2019live>
and also available for viewing in two working rooms:
 - Festival Room, Lower Level of Memorial Union
 - Inn Wisconsin, 2nd Floor of Memorial Union
- Presentations available at:
<https://wisconsinunion.sharefile.com/i/i767e47a8b6642c18>

Presenters,

- please upload your presentations,
- in addition to providing them to the session organizers before the session.

Sustainability

- We are making an effort to reduce waste
- Please use your ICRC 2019 tumblers instead of disposable cups and plastic glasses
- Thank you for your support



alamy stock photo

APC/JCT
www.alamy.com

Noteworthy Programming & Events

Messages

Memorial Union Gallery

Event Horizon: Have your portrait taken and added to the show **today**
10:00 -18:00

Messages from the Horizon:
A sound and light experience exploring what and how we know

Presented by Wisconsin Union Directorate Art Committee.



Equity in Science: Realities and Responses

Panel Discussion and
Ice Cream Social

Thursday, July 25
18:30-20:30
"Old Madison", 3rd Floor

Seating limited to 100
First come, first served

Capturing Cosmic Ray Scientists: The Making of the Memorial Union Event Horizon Gallery Show

Dr. Faisal Abdu'Allah

Monday, July 29
12:00-13:30
"Old Madison", 3rd Floor

Limited to 50 (lunch provided)
First come, first served



Enjoy your time in Madison!

Madison has a lot to offer:

- Iconic State Street (an array of shops and restaurants just blocks away)
- Wisconsin State Capitol (guided tours)
- Memorial Union Terrace (enjoy drinks, food and live music)
- Many scenic parks including the University of Wisconsin–Madison Arboretum and Olbrich Botanical Gardens
- See our local expert from **Destination Madison**; see also <https://www.visitmadison.com/>



ICRC2019

Madison, WI, USA

Special Thanks to Our Sponsors



HAMAMATSU

